

VisWall™ 4K

High Resolution PowerWall Display

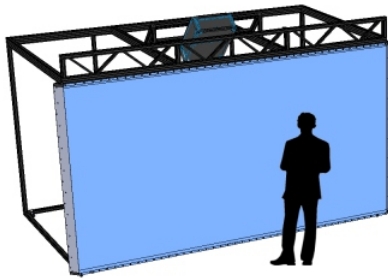

The **VisWall™ 4K** is a high resolution PowerWall display wall. The VisWall-4K features a large rear-projection wall. This system can be configured as a standalone display or as a turn-key immersive virtual reality system, complete with a tracking system and graphics workstation.

The VisWall 4K features projectors with a **laser light source**, providing stable color and eliminating lamp replacements.

Key Features:

- High resolution PowerWall display wall
- Free-standing or in-wall (e.g. conference room)
- Extra large **14.3' wide screen**
- **4K (4096x2160) resolution** projector
- **Laser light source** stable color, no lamp changes
- Multi-use: mono, stereo 3D, tracked stereo 3D (VR)
- Custom configurations available

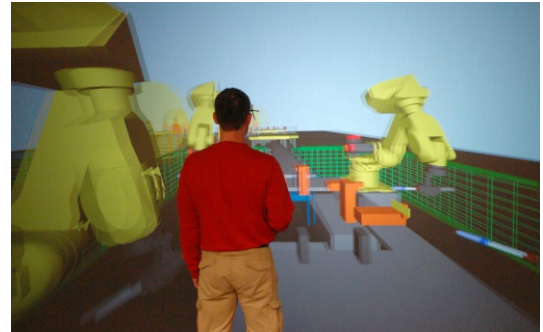

VisWall 4K Datasheet

visbox System Specifications

- Resolution: 4096x2160
- Screen size: 172" w x 91" h
- Footprint: 14.3' w x 8.2' d x 9.5' h (approx)

Includes:

- Active stereo 3D capable 4K projector (4096x2160)
- Laser light source: stable color, no lamp changes
- In-wall or free-standing structure
- Custom projector positioner
- Active Stereo and 10 pairs of shutter glasses
- Video, projector control, projector sync, and power cabling
- Installed and calibrated on-site by Visbox, Inc.



Image Generator

- Graphics workstation with NVIDIA Quadro graphics
- 19" APC rack and all cabling
- Control console with monitor/keyboard/mouse
- Software demos, applications, and development libraries

Option: A.R.T. Optical Tracking

- ARTTRACK5 system (4 high resolution cameras)
- Tracked head, tracked wand (controller)



Option: Sound System

- Soundbar and subwoofer (4.1)



Option: Light Block

- Fabric enclosing system
- Blocks ambient light and restricts access

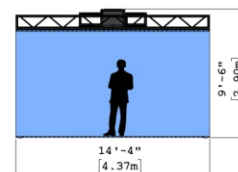
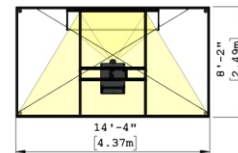

Other VisWall Models

VisWall-T3: 10' or 12' wide, 4096x2560
 VisWall-T4: 12' wide, 4600x2875, only 30" deep
 VisWall Custom: custom resolution and screen size
 VisWall-LCD: array of LCD panels

Information in this brochure is subject to change without any notice. For up-to-date information and to learn more about Visbox, Inc.'s various products and services, please visit our website at:

www.visbox.com

Contact Us:

Visbox, Inc.
 304 Northgate Drive
 St. Joseph, IL 61873 USA

www.visbox.com
 sales@visbox.com
 1-217-469-2020

VisWall™ T3W, T3

High Resolution PowerWall Display

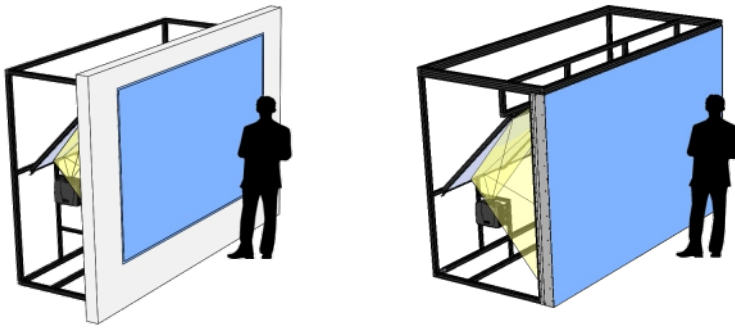

The **VisWall™ T3W** and **VisWall™ T3** are high resolution PowerWall display walls. The VisWall T3W and VisWall T3 feature a large rear-projection wall. These systems can be configured as a standalone display or as a turn-key immersive virtual reality system, complete with a tracking system and graphics workstation.

Key Features:

- High resolution PowerWall display wall
- Free-standing or in-wall (e.g. conference room)
- Extra large **10' or 12' wide screen**
- **4096x2560 resolution**
- Multi-use: mono, stereo 3D, tracked stereo 3D (VR)
- Custom configurations available

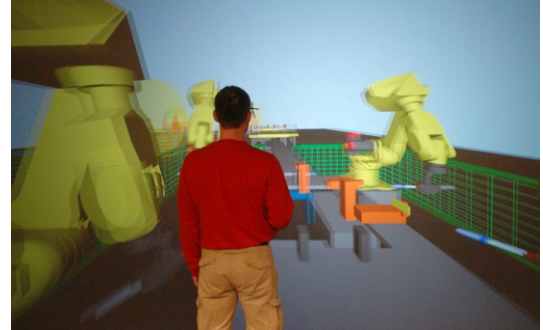

VisWall T3W, T3 Datasheet

visbox System Specifications

- Resolution: 4096x2560
- Screen size: 120" w x 75" h (T3W) or 144" w x 90" h (T3)
- Footprint for T3W: 10.5' w x 4.5' d x 8.5' h (approx)
- Footprint for T3: 12' w x 5.6' d x 8.5' h (approx)
- Includes:
 - 3 active stereo projectors (2560x1600 each)
 - Digital edge blending
 - Free-standing structure with front-surface mirrors
 - In-wall option (T3W)
 - Custom projector positioners
 - Active Stereo and 10 pairs of shutter glasses
 - Video, projector control, projector sync, and power cabling
 - Installed and calibrated on-site by Visbox, Inc.



Image Generator

- Graphics workstation with NVIDIA Quadro graphics
- 19" APC rack and all cabling
- Control console with monitor/keyboard/mouse
- Software demos, applications, and development libraries



Option: A.R.T. Optical Tracking

- ARTTRACK5 system (4 high resolution cameras)
- Tracked head, tracked wand (controller)



Option: Sound System

- Soundbar and subwoofer (4.1)

Option: Light Block

- Fabric enclosing system
- Blocks ambient light and restricts access

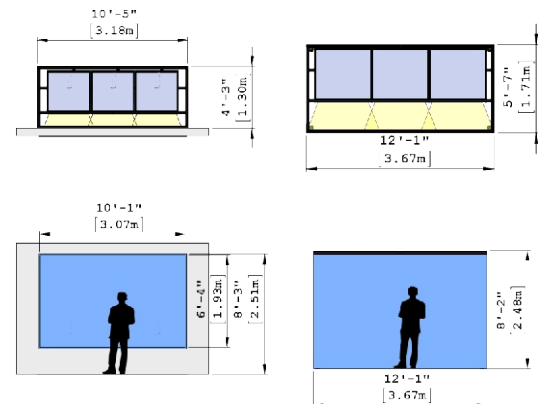

VisWall T3W (in-wall)

VisWall T3

Other VisWall Models

VisWall-4K: 14.3' wide, 4096x2160

VisWall-T4: 12' wide, 4600x2875, only 30" deep

VisWall Custom: custom resolution and screen size

VisWall-LCD: array of LCD panels

Information in this brochure is subject to change without any notice. For up-to-date information and to learn more about Visbox, Inc.'s various products and services, please visit our website at:

www.visbox.com

Contact Us:

Visbox, Inc.
304 Northgate Drive
St. Joseph, IL 61873 USA

www.visbox.com
sales@visbox.com
1-217-469-2020

VisWall™ T4

High Resolution PowerWall Display

visbox

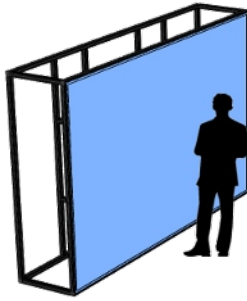

The **VisWall™ T4** are high resolution PowerWall display walls. The VisWall T4 features a large rear-projection screen with only 30" of depth behind the screen. These systems can be configured as a standalone display or as a turn-key immersive virtual reality system, complete with a tracking system and graphics workstation.

VisWall T4 Datasheet

visbox System Specifications

- Resolution: 4600x2875
- Screen size: 144" w x 90" h
- Footprint: 12' w x 2.5' d x 8' h (approx)
- Includes:
 - 4 active stereo projectors (2560x1600 each)
 - Digital edge blending
 - Free-standing structure
 - Custom projector positioners
 - Active Stereo and 10 pairs of shutter glasses
 - Video, projector control, projector sync, and power cabling
 - Installed and calibrated on-site by Visbox, Inc.



Image Generator

- Graphics workstation with NVIDIA Quadro graphics
- 19" APC rack and all cabling
- Control console with monitor/keyboard/mouse
- Software demos, applications, and development libraries



Option: A.R.T. Optical Tracking

- ARTTRACK5 system (4 high resolution cameras)
- Tracked head, tracked wand (controller)



Option: Sound System

- Soundbar and subwoofer (4.1)

Option: Light Block

- Fabric enclosing system
- Blocks ambient light and restricts access

Key Features:

- High resolution PowerWall display wall
- Free-standing structure, **only 30" deep**
- Extra large **12' wide screen**
- **4600x2875 resolution**
- Multi-use: mono, stereo 3D, tracked stereo 3D (VR)
- Custom configurations available

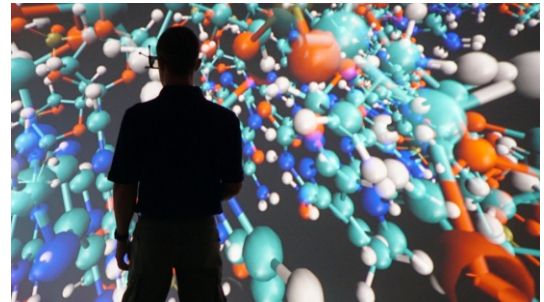

Ultra Resolution

The VisWall T4 features a large screen size and projectors that are stereo 3D capable. The result is a display that can run high resolution applications and immersive 3D applications.

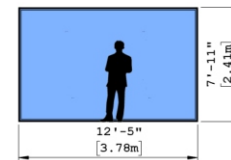
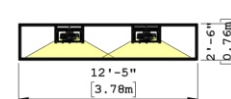

Other VisWall Models

VisWall-4K: 14.3' wide, 4096x2160
 VisWall-T3W, T3: 10' or 12' wide, 4096x2560
 VisWall Custom: custom resolution and screen size
 VisWall-LCD: array of LCD panels

Information in this brochure is subject to change without any notice. For up-to-date information and to learn more about Visbox, Inc.'s various products and services, please visit our website at:

www.visbox.com

Contact Us:

Visbox, Inc.
 304 Northgate Drive
 St. Joseph, IL 61873 USA

www.visbox.com
sales@visbox.com
 1-217-469-2020

Custom VisWall™

High Resolution PowerWall Display Wall

visbox

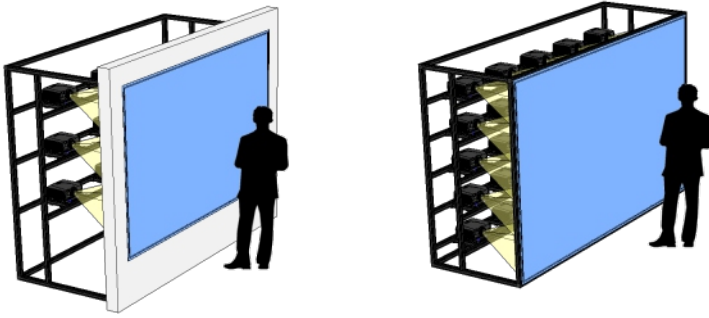

The **VisWall™** is a scalable high resolution PowerWall display. The tiled display wall is achieved by the highly accurate alignment of multiple separate projectors. The VisWall allows small groups of people to collaboratively examine incredibly detailed imagery or incredible amounts of information at once.

The VisWall is custom designed and built for each customer according to size and resolution needs. Considerations include individual projector resolution, number of projectors, individual tile size, aggregate resolution, aggregate aspect ratio (4:3, 16:9, other), aggregate physical size, throw distance (space behind screen), pixel density (pixels per inch), etc. Often, a customer has certain needs (e.g. Aggregate resolution) and constraints (e.g. Size of room) that help determine the appropriate solution.

VisWall Datasheet



System Specifications

- Resolution: see table on right
- Screen: rear projection, wide range of sizes
- Includes:
 - High quality rear-projection screen
 - Free-standing aluminum support structure or in-wall
 - Custom projector positioners for precise alignment
 - High quality, bright digital projectors mounted on positioners
 - Video, projector control, projector sync, and power cabling
 - Installed and calibrated on-site by Visbox, Inc.



3D Active Stereo

- Active stereo emitter/hub
- 10 pairs of 3D shutter glasses



Image Generator

- One high-end graphics workstation
- Multiple Nvidia Quadro graphics cards



Rendering Cluster for large VisWalls (>16 tiles)

- One high-end workstation (the head console display)
- Cluster of rendering nodes with high-end graphics
- High-speed cluster network for optimal performance

Option: Edge Blending

- Digital edge blending
- Provides smooth transition between tiles
- Decreases overall resolution due to overlap regions



Option: A.R.T. Optical Tracking

- TrackPack4 or ARTTRACK5 system (4 cameras)
- Tracked head, tracked wand (controller)

Option: Light Block

- Fabric to enclose free-standing system
- Blocks ambient light and restricts access

Other options are also available

Information in this brochure is subject to change without any notice. For up-to-date information and to learn more about Visbox, Inc.'s various products and services, please visit our website at:

www.visbox.com

Key Features:

- Scalable, extremely high resolutions possible
- Custom configurations available (size and resolution)
- Free-standing or in-wall (e.g. conference room)
- Custom projector positioners for precise alignment
- Size is ideal for small groups of people working together
- Multi-use: mono, stereo 3D, tracked stereo 3D (VR)



High Resolution Applications

The VisWall enables very high resolution collaborative visualization. As the data generated by simulations or acquired from various instruments gets larger, it becomes crucial to visualize that data with a sufficiently high resolution display. Conventional display technology fails to address this issue, with the resolution of displays increasing far slower than the size of the data. The VisWall addresses this problem by providing a scalable display solution, allowing researchers to gain more insight into their data.

Example configurations:

VisWall-T4	5120x3200	~16.4 Mpixels
VisWall-T9	7680x4800	~36.9 Mpixels
VisWall-T16	10240x6400	~65.5 Mpixels
VisWall-T25	12800x8000	~102.4 Mpixels

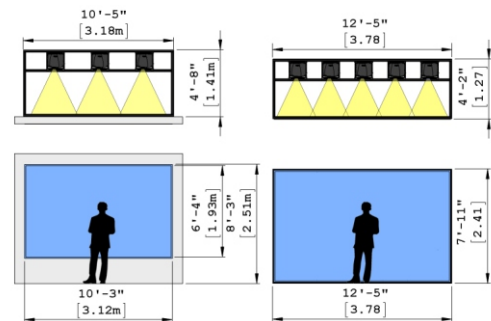

VisWall-T9W (in-wall)

VisWall-T25

Other VisWall Models

VisWall-4K	4096x2160	~8.9 Mpixels
VisWall-T3	4096x2560	~10.5 Mpixels
VisWall-T4	4600x2875	~13.2 Mpixels
VisWall-LCD	array of LCD panels	

Contact Us:

Visbox, Inc.
304 Northgate Drive
St. Joseph, IL 61873 USA

www.visbox.com
sales@visbox.com
1-217-469-2020

VisWall-LCD™

High Resolution Display



The **VisWall-LCD™** is an affordable and scalable high resolution display achieved by tiling LCD flat panel displays. High resolution panels with minimum bezels are used. However, for seamless display, the VisWall product (projector based) is more appropriate.

Much like a VisWall, a VisWall-LCD allows small groups of people to collaboratively examine incredibly detailed imagery or incredible amounts of information at once.

The specifications for two standard configurations are shown below. These are freestanding, height adjustable and portable units. Multiple units can be used to create larger display configurations. Custom configurations are also available with different numbers and types of panels.

Key Features:

- Scalable, extremely high resolutions possible
- Custom configurations (type and number of panels)
- High resolution panels with minimal bezels
- Size is ideal for small groups of people working together



VisWall-LCD-6WQ Datasheet



System Specifications

- **Panel Resolution: 2560x1600**
- Aggregate Resolution: 5120x4800
- Panel size: 30" diagonal
- Bezel size: 24.5mm (49mm image to image)
- Display size: 54.4" w x 53.1" h
- Footprint: 54.4" w x 61"-78" h x 21" d (approx)

Includes:

- Six WQXGA LCD panels in 2w x 3h array
- Height adjustable panel mounting grid
- Six adjustable panel mounts
- Base enclosure with power and video cable management
- Image generator with NVIDIA graphics (6 DVI outputs)
- Video and power cabling



Multiple units can be used side-by-side to create larger display systems.

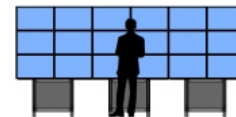
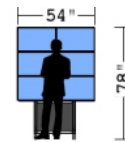

VisWall-LCD-3HD, VisWall-LCD-4HD



System Specifications

- Panel Resolution: 1920x1080
- Aggregate Resolution: 1920x3240 (1x3) or 3480x2160 (2x2)
- Panel size: 55" diagonal
- **Bezel size: 1.8mm, 3.7mm (5.5mm image to image)**
- Display size: 47.6" w x 80.4" h (1x3) or 95.2" w x 53.6" h (2x2)
- Footprint: 47.6" x 86"-96" h x 21" d (1x3, approx) or 95.2" x 73"-85" h x 28" d (2x2, approx)

Includes:

- 3 or 4 HD ultra narrow bezel LCD panels in 1x3 or 2x2 array
- Height adjustable panel mounting grid
- 3 or 4 adjustable panel mounts
- Base enclosure with power and video cable management
- Image generator with NVIDIA graphics (4 DVI outputs)
- Video and power cabling



Multiple units can be used side-by-side to create larger display systems.

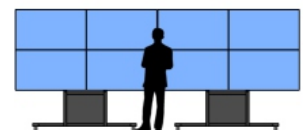
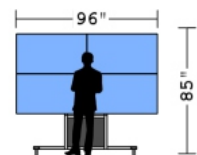
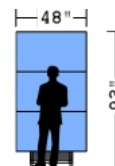

Information in this brochure is subject to change without any notice. For up-to-date information and to learn more about Visbox, Inc.'s various products and services, please visit our website at:

www.visbox.com

Contact Us:

Visbox, Inc.
304 Northgate Drive
St. Joseph, IL 61873 USA

www.visbox.com
sales@visbox.com
1-217-469-2020